

vtech®

Parent's Guide

Disney

**Toot-Toot
Drivers®**

Mickey's Happy House

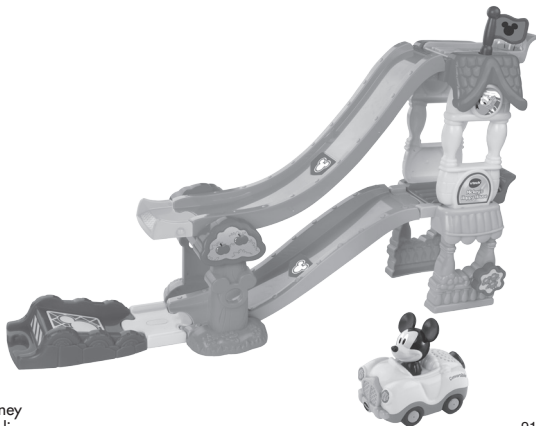

© Disney
www.disney.com

91-003532-001 

VTech understands that a child's needs and abilities change as they grow and with that in mind we develop our toys to teach and entertain at just the right level...

vtech Baby

Toys that will stimulate their interest in different textures, sounds and colours

I am...

...responding to colours, sounds and textures

...understanding cause and effect

...learning to touch, reach, grasp, sit-up, crawl and toddle

Birth-36 months



Pre-School

Interactive toys to develop their imagination and encourage language development

I want...

...to get ready for school by starting to learn the alphabet and counting

...my learning to be as fun, easy and exciting as can be

...to show my creativity with drawing and music so my whole brain develops

3-6 years



Electronic Learning Computers

Cool, aspirational and inspiring computers for curriculum related learning

I need...

...challenging activities that can keep pace with my growing mind

...intelligent technology that adapts to my level of learning

...National Curriculum based content to support what I'm learning at school

4-10 years



To learn more about this and other VTech® products, visit www.vtech.co.uk

INTRODUCTION

Thank you for purchasing the **VTech® Toot-Toot Drivers® Mickey's Happy House!** Little racers can rearrange the tracks to create a dual raceway, stunt track or super raceway and speed through the day.

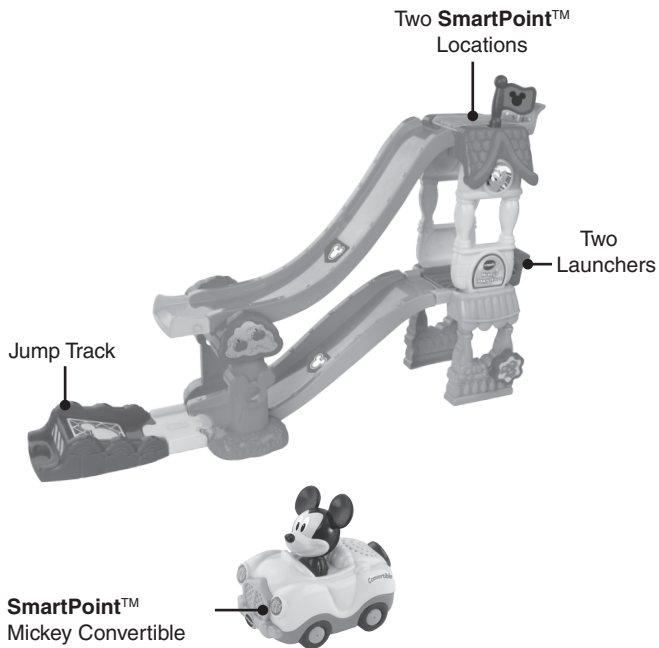

INCLUDED IN THIS PACKAGE



One **SmartPoint™**
Mickey Convertible



One small platform



Two small platform
supports



One large platform



One flag



Two large platform
supports



Two bridge
supports

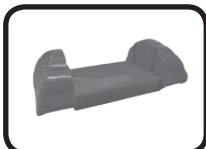

One bridge



Two ramp tracks



One 1/4 track,
male



One jump track,
female



One end track,
male



One label sheet

- One parent's guide

WARNING:

All packing materials such as tape, plastic sheets, packaging locks, removable tags, cable ties and packaging screws are not part of this toy, and should be discarded for your child's safety.

NOTE: Please keep this parent's guide as it contains important information.

Adult assembly required. For your child's safety, do not let your child play with the toy until it is fully assembled.

Unlock the packaging locks:

- ① Turn the packaging locks anticlockwise several times.
- ② Pull out and discard the packaging locks.

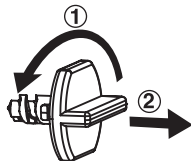

GETTING STARTED

BATTERY INSTALLATION

Convertible

1. Make sure the unit is turned **OFF**.
2. Locate the battery cover on the bottom of the **Convertible**. Use a screwdriver to loosen the screw.
3. Install 2 new AAA (AM-4/LR03) batteries following the diagram inside the battery box. (The use of new alkaline batteries is recommended for maximum performance).
4. Replace the battery cover and tighten the screw to secure the battery cover.

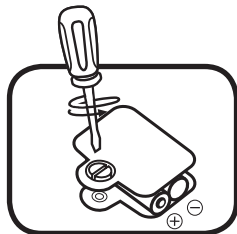

BATTERY NOTICE

- Use only batteries of the same or equivalent type as recommended.
- Do not mix different types of batteries: alkaline, standard (carbon-zinc) or rechargeable, or new and used batteries.
- Do not use damaged batteries.
- Insert batteries with the correct polarity.
- Do not short-circuit the battery terminals.
- Remove exhausted batteries from the toy.
- Remove batteries during long periods of non-use.
- Do not dispose of batteries in fire.
- Do not charge non-rechargeable batteries.
- Remove rechargeable batteries from the toy before charging (if removable).
- Rechargeable batteries are only to be charged under adult supervision.

Disposal of batteries and product



The crossed-out wheellie bin symbols on products and batteries, or on their respective packaging, indicates they must not be disposed of in domestic waste as they contain substances that can be damaging to the environment and human health.



The chemical symbols Hg, Cd or Pb, where marked, indicate that the battery contains more than the specified value of mercury (Hg), cadmium (Cd) or lead (Pb) set out in Battery Directive (2006/66/EC).

The solid bar indicates that the product was placed on the market after 13th August, 2005.



Help protect the environment by disposing of your product or batteries responsibly.

For more information, please visit:

www.recycle-more.co.uk

www.recyclenow.com

LABEL APPLICATION

Please adhere the labels to the play set securely as indicated on the following page:

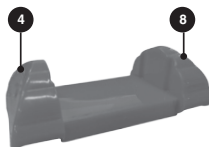
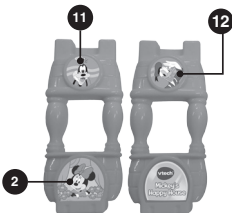
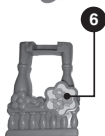
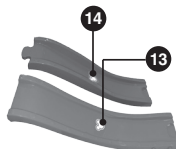
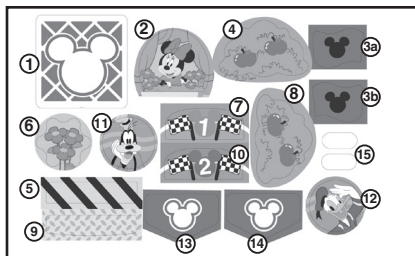

ASSEMBLY INSTRUCTIONS

Mickey's Happy House

With the VTech® Toot-Toot Drivers® Mickey's Happy House, safety comes first. To ensure your child's safety, adult assembly is required.

1. Attach the **Small Platform Supports** to the **Small Platform**. You will hear a “click” sound to indicate the pieces are secure. Once the pieces are connected, they cannot be detached.



2. Insert the **Flag** into the **Large Platform**. Then, attach the **Large Platform Supports** to the **Large Platform**. You will hear a “click” sound to indicate the pieces are secure. Once the pieces are connected, they cannot be detached.

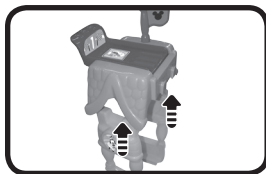

3. Attach the **Bridge Supports** to the **Bridge**.

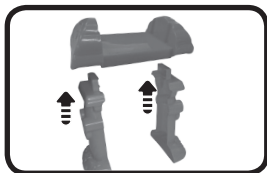

After the above steps, connect these pieces to the included track pieces. You can configure them into different shapes.

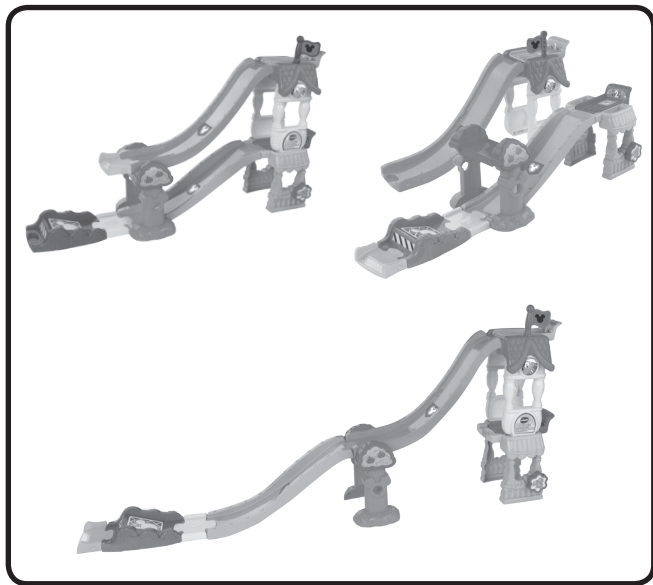

EXPAND & EXPLORE

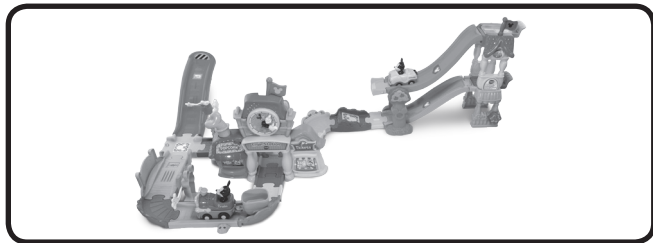

You are now ready to play! Connect the track pieces together or use them to connect other **Toot-Toot Drivers®** play sets and tracks (each sold separately).



PRODUCT FEATURES

Convertible

1. ON/OFF SWITCH

To turn the unit **ON**, slide the **On/Off Switch** to the **ON** () position. To turn the unit **OFF**, slide the **On/Off Switch** to the **OFF** () position.

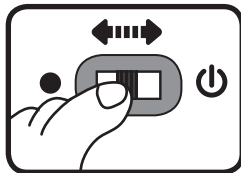

2. AUTOMATIC SHUT-OFF

To preserve battery life, the included **Convertible** will automatically power down after approximately 50 seconds without input. The unit can be turned on again by pressing the **Character Button** or by pushing the **Convertible** quickly.

Note: This product is in try-me mode in the packaging. After opening the package, turn the vehicle off and on again to proceed with normal play. If the unit powers down while playing, we suggest changing the batteries.

ACTIVITIES

Convertible

1. Slide the **On/Off Switch** to the **ON** position to turn the unit **ON**. You will hear a song, a phrase and sounds. The lights will flash with the sounds.

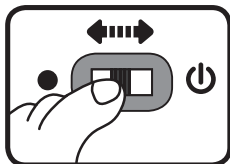

2. Press the **Character Button** to hear fun sounds, songs and phrases. The lights will flash with the sounds.

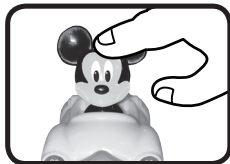

3. Push the **Convertible** to hear fun sounds and melodies. While the melody is playing, push the vehicle again to add in fun sounds on top of the melody. The lights will flash with the sounds.

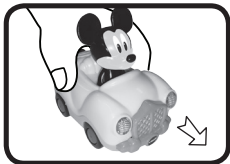

4. For added fun, the **Convertible** interacts with the **Toot-Toot Drivers® Mickey's Happy House**. Simply put the vehicle on one of the play set's two **SmartPoint™** launchers to see the **Convertible's** lights flash and to hear fun phrases, short tunes and sounds. The **Convertible** even interacts with other **Toot-Toot Drivers®** play sets and tracks (each sold separately).

ACTIVITIES

Mickey's Happy House

1. Place the **Convertible** on either of the play set's two **SmartPoint™** locations to trigger fun sounds, phrases and music.
2. Configure the play set in different ways for added fun and creative play.
3. Place the vehicle on the launchers to launch and jump the vehicle.

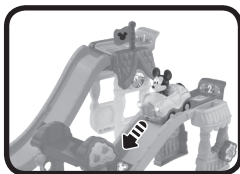
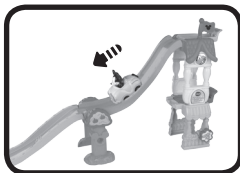
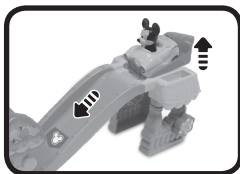

SONGS

1. Beep, beep, honk, honk,
Ready to go,
Buckle up, be safe on the road.
2. Oh, my convertible's super,
Oh, my convertible's super,
Oh, my convertible's super,
Which nobody can deny!
3. Take a trip 'round the town!

MELODY LIST

1. Baa, Baa, Black Sheep
2. For He's a Jolly Good Fellow
3. Bingo
4. Can Can
5. Glow Worm
6. Pop Goes the Weasel

CARE & MAINTENANCE

1. Keep the unit clean by wiping it with a slightly damp cloth.
2. Keep the unit out of direct sunlight and away from any direct heat source.
3. Remove the batteries when the unit will not be in use for an extended period of time.
4. Do not drop the unit on hard surfaces and do not expose the unit to moisture or water.

TROUBLESHOOTING

If for some reason the unit stops working or malfunctions, please follow these steps:

1. Please turn the unit **OFF**.
2. Interrupt the power supply by removing the batteries.
3. Let the unit sit for a few minutes, then replace the batteries.
4. Turn the unit **ON**. The unit should now be ready to play with again.
5. If the product still does not work, install a brand new set of batteries.

If the problem persists, please call our Consumer Services Department on 0330 678 0149 (from UK) or + 44 330 678 0149 (outside UK) and a service representative will be happy to help you.

IMPORTANT NOTE:

Creating and developing VTech® products is accompanied by a responsibility that we take very seriously. We make every effort to ensure the accuracy of the information, which forms the value of our products. However, errors sometimes can occur. It is important for you to know that we stand behind our products and encourage you to call our Consumer Services Department on 0330 678 0149 (from UK) or + 44 330 678 0149 (outside UK), with any problems and/or suggestions that you might have. A service representative will be happy to help you.

CLASS 1
LED PRODUCT



PRODUCT REGISTRATION

Visit www.vtech.co.uk/clubvtech/login
to register your VTech product

By joining the VTech Club you can also enter competitions, find out about news and events, seek expert advice for parents and let your kids play fun learning games and activities.



PRODUCT WARRANTY

Thank you for choosing this quality product from VTech. We hope it will bring many hours of entertainment, imaginative play and learning.

1. The product detailed above is covered by a one year warranty from the date of purchase, against any defects in materials or workmanship.
2. The product may be returned to the place of purchase. Alternatively the product can be returned to VTech Electronics Europe plc (see address below), with proof of purchase, without proof of purchase no replacement will be provided.
3. VTech Electronics Europe plc will examine the product and if it is found to be defective due to faulty materials or workmanship, will replace the product at their discretion.
4. If the product covered by this warranty is damaged due to misuse, modification or unauthorised repair, or because of faulty batteries, battery discharge or incorrect electrical connections, then this warranty becomes void.
5. This warranty is personal to the original purchaser and is not transferable.
6. Breakages to the LCD screen are not covered by the warranty.
7. Returns to VTech Electronics Europe plc should include a cheque or postal order for £1.50 towards the cost of return postage and packaging.
8. Products returned to VTech Electronics Europe plc, should be addressed as follows and packed carefully to avoid damage in transit (Please do not include batteries or adaptor). Please include details of the fault together with your name and address.
9. To keep an online record of your warranty, please register your product online at www.vtech.co.uk/warranty

VTech Electronics EU PLC, c/o XPO Logistics, Warehouse 350, Cat & Fiddle Lane, West Hallam, DE7 6HE

THIS WARRANTY IS OFFERED AS AN EXTRA BENEFIT AND DOES NOT AFFECT CONSUMERS' STATUTORY RIGHTS.

This warranty is valid for the UK and Eire only. For products purchased outside the UK and Eire, please contact your local distributor or place of purchase.





**Visit our website for more
information about our products,
downloads, resources and more.**

vtech.co.uk



TM & © 2018 VTech Holdings Limited.
All rights reserved.
Printed in China.
91-003532-001 